

PLAN VIEW

NOTES:

1. TRANSVERSE EXPANSION JOINTS TO BE A MAXIMUM OF 50 FEET.
2. ALL CONCRETE TO BE FINISHED WITH CURING COMPOUND.
3. A 6 INCH DEPTH IS REQUIRED AT LOCATIONS OF DRIVEWAY CROSSINGS, AT STREET INTERSECTIONS (ALONG THE LENGTH OF RADIUS CURB RETURNS), AND IN THE HANDICAP RAMPS.
4. ALL SIDEWALK MUST BE INSPECTED BY CITY INSPECTOR PRIOR TO CONCRETE PLACEMENT.
5. SIDEWALK CROSS SLOPE WILL BE A MAXIMUM OF 0.02'/1' PER ADA REQUIREMENTS.
6. ALL SIDEWALK WILL BE LEFT IN A BROOM FINISH CONDITION.
7. CONTRACTOR MUST REPAIR ALL DAMAGE TO SIDEWALK PRIOR TO TRANSFER OF OWNERSHIP.
8. EXPANSION JOINT MATERIAL TO BE INSTALLED AT ALL LOCATIONS WHERE SIDEWALK ABUTS A RIGID STRUCTURE.
9. ALL EXPANSION JOINTS TO BE SEALED WITH POLYMER SEALANT MEETING ASTM C920

TRANSVERSE EXPANSION JOINT

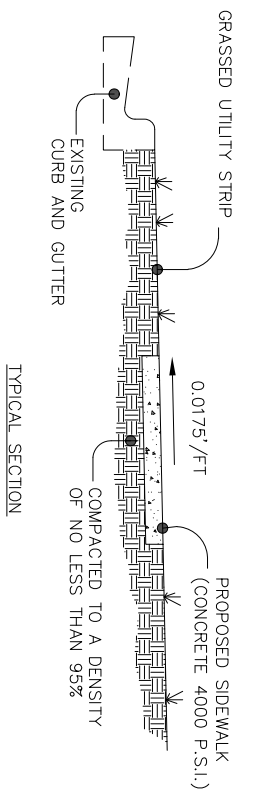
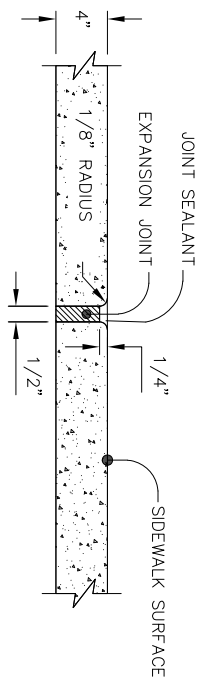

TYPICAL SECTION

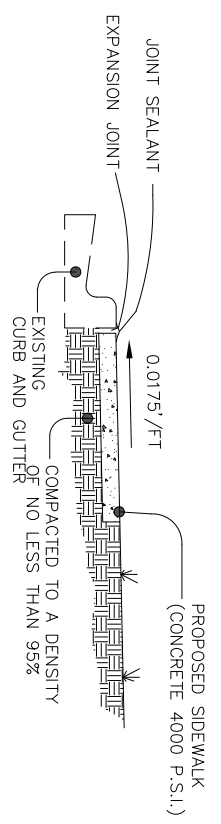

TYPICAL SECTION NO. GRASS STRIP

STANDARD CONCRETE SIDEWALK

DATE: 05/19/2023  
 SCALE: NOT TO SCALE  
 WD DWG. NO. 22

City of Hendersonville Engineering Department  
 305 Williams Street  
 Hendersonville, NC 28792  
 (828) 697-3000 (office)  
[www.cityofhendersonville.org](http://www.cityofhendersonville.org)

